

# REPLACEMENT PARTS SUITABLE FOR TRAFIMET®

## A140/P140

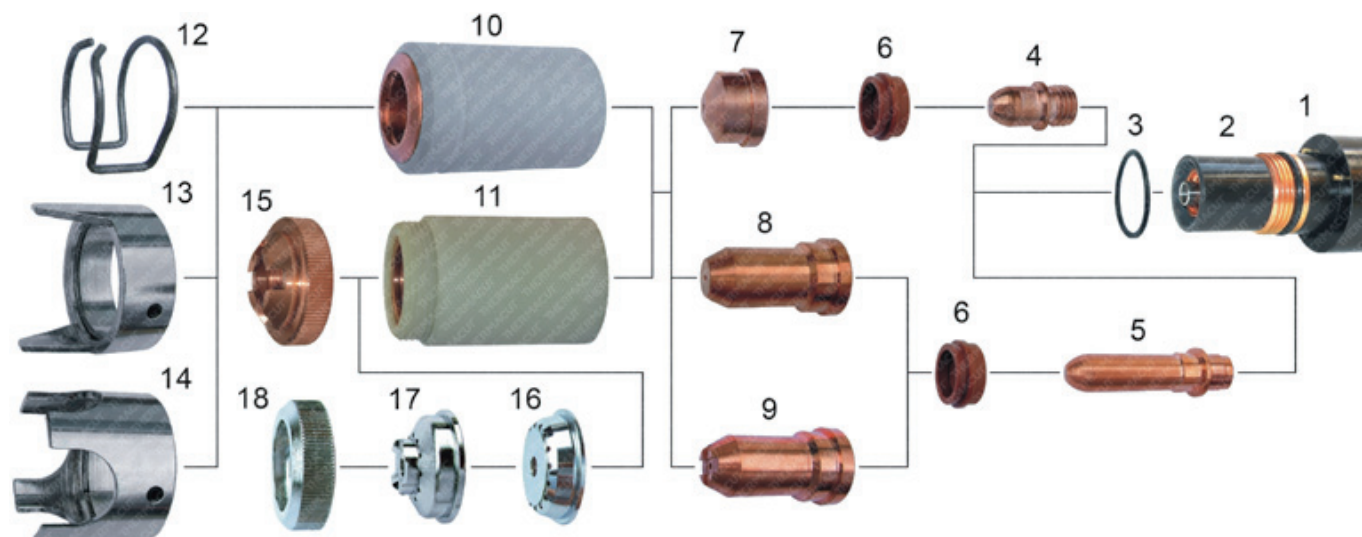

Item	Part No.	Ref. No.	Description	Std. Pkg.	Item	Part No.	Ref. No.	Description	Std. Pkg.
1.	TN-0109	PF101	Torch Body, Hand	1	11.	T-5013	PC103	Contact Nozzle Ret. Cap	1
	TN-0106	PF102	Torch Body, Machine	1	12.	T-3718	CV11	Spacer Spring	5
2.	T-11289	T-11289	Insulator (only for TMT torch)	1	13.	T-0643	CV12(1408)	Double Pointed Spacer	1
3.	T-3562	EA131	O - Ring	1	14.	T-5003	CV14	Crown Spacer	6
4.	T-5059	PR101	Electrode	10	15.	T-5004	CV23	Shield Cup	6
5.	T-5065	PR116	Electrode, Long – no thread	5	16.	T-9372		Shield Cup, Machine	1
6.	T-5072	PE101	Swirl Ring	2	17.	T-9370		Spacer for Contact Cutting	1
7.	T-2926	PD101-11	Nozzle 1.1mm	5	18.	T-9375		Locking Nut	1
	T-3349	PD101-14	Nozzle 1.4mm	5	NS	T-5069	TP12	Insulating Sleeve	1
	T-2955	PD101-17	Nozzle 1.7mm	5	NS	T-5068	TP10	Handle with Switch	1
	T-2954	PD101-19	Nozzle 1.9mm	5	NS	KT-1100	PH148	A140® Cable Leads 6m, Hand, fittings	1
8.	T-5032	PD117-14	Nozzle, Long 1.4mm	10	NS	KT-1219	PA101	A140® Hand Torch with Leads 6m, fittings	1
	T-5033	PD117-17	Nozzle, Long 1.7mm	10	NS	KT-1050	PA214	A140® Hand Torch with Leads 6m, centr.conn.	1
	T-5034	PD117-19	Nozzle, Long 1,9mm	10	NS	KT-1053	PA219	A140® Hand Torch with Leads 12m, centr.conn.	1
9.	T-9527	PD111	Nozzle, Gouging	1	NS	KT-1260	K.P140-M.8,5M.CK.K	P140® Cable Leads 8,5m, Hand/Mach., fittings	1
10.	T-10409	PC101	Nozzle Retaining Cap	1	NS	KT-1119	PA146	P140® Mach. Torch with Leads 12m, centr.conn.	1